

710 MINISIT

MAIN FEATURES

- Thermoelectric flame supervision device with interlock
- Control knob with positions for temperature selection
- Modulating and on-off thermostat
- Pressure regulator or alternatively flow adjuster
- Pilot outlet with pre-setting device of the gas flow
- Inlet and pilot filter
- Inlet and outlet pressure test point
- Inline main gas inlet and outlet or bottom outlet
- Main gas connections with threaded pipe, flange or suitable for nut and olive
- Piezo igniter (optional)

DESCRIPTION

- 1 Ignition button
- 2 Shut-down button
- 3 Piezo-electric ignition button (optional)
- 4 Temperature setting knob
- 5 Screw for adjusting gas flow to pilot
- 6 Minimum flow setting screw
- 7 Maximum flow setting screw (versions with flow regulator)
- 8 Outlet pressure setting screw (versions with flow regulator)
- 9 Inlet pressure test point
- 10 Outlet pressure test point
- 11 Thermocouple connection
- 12 Pilot outlet
- 13 Gas inlet
- 14 Main gas outlet
- 15 Flange fixing holes (M4)
- 16 Fixing points
- 17 Thermostat bulb

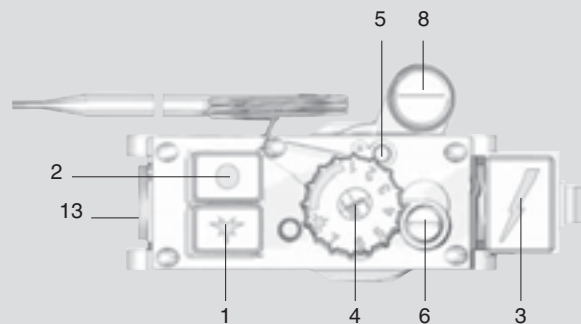

(Version with pressure regulator)

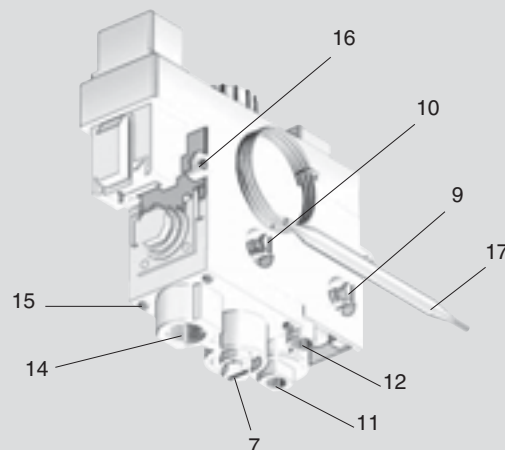

(Version with flow regulator and bottom gas outlet)

CONFIGURATIONS

VALVE CONFIGURATION

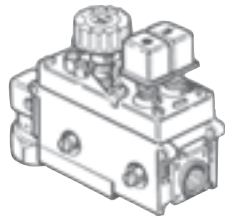

A

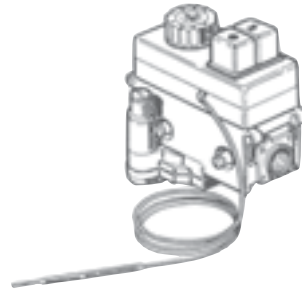

B

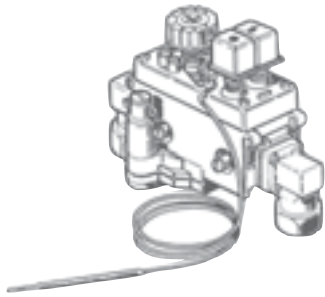

C

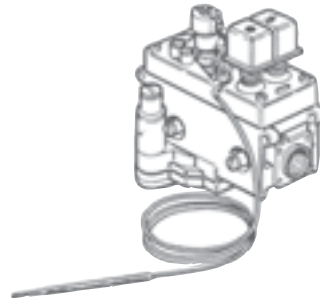

D

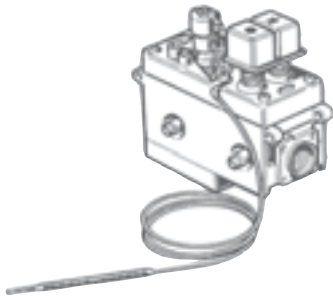

E

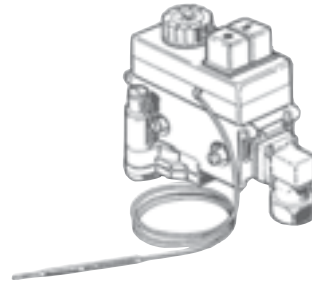

F

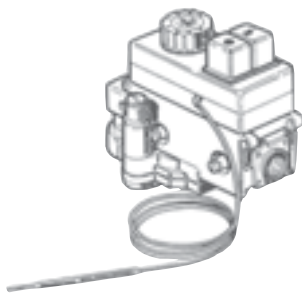

G

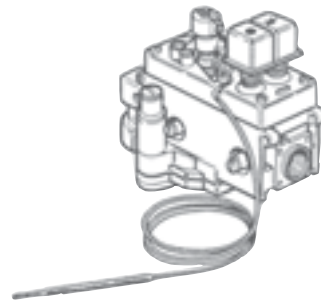

H

BULB CONFIGURATION



M



N



P



R

CODES

Codes	RoHS Version	TC connection	Magnet Unit: [Drop out- hold in current, mA]	PTP (1)	Pilot connection	Inlet thread	inlet FLANGE (2)	Inlet elbow orient.	NUT	OLIVE	Reducer	Outlet thread	Outlet FLANGE	Outlet elbow fi. orient.	NUT	OLIVE
0710004	M10x1	>40 <200	Yes	Ø 4 mm , 16 mm long	1/2"	no	20 mm long	ø 16 mm	3/8"	elbow 3/8"	Bottom	yes	ø 12 mm			
0710005	M10x1	>40 <200	Yes	Ø 4 mm , 16 mm long	1/2"	no	20 mm long	ø 16 mm	3/8"	elbow 3/8"	Bottom	yes	ø 12 mm			
0710021	M9x1	>40 <200	yes	Ø 4 mm , 16 mm long	3/8"	no	no	no	1/2"-3/8"	bottom 3/8"	No					
0710022	M9x1	>40 <200	Yes	Ø 4 mm , 16 mm long	3/8"	no	no	no	1/2"-3/8"	bottom 3/8"	No					
0710029	M10x1	>110 <340 (red mark)	Yes	Ø 4 mm , 16 mm long	3/8"	Elbow 3/8"	Bottom	yes	ø 12 mm	3/8"	Straight brass 30 mm long (0.974.085)	No	yes	ø 12 mm		
0710030	M10x1	>40 <200	Yes	Ø 4 mm , 16 mm long	1/2"	Elbow 1/2"	Bottom	yes	ø 16 mm	3/8"	Straight brass 60 mm	No	yes	ø 16 mm		
0710031	M10x1	>40 <200	Yes	Ø 4 mm , 16 mm long	3/8"	no	20 mm long	ø 12 mm	3/8"	Straight brass 60 mm	No	yes	ø 12 mm			
0710059	M10x1	>40 <200	Yes	Ø 4 mm , 16 mm long	1/2"	no	no	fitted	3/8"	Elbow 3/8" + P.T.Point sx Rc1/8"	Bottom	no	ø 12 mm			
0710063	M9x1	>110 <340 (red mark)	Yes	Ø 6 mm , 16 mm long	3/8"	no	20 mm long	ø 12 mm	3/8"	Elbow 3/8" + P.T.Point front Rc1/8"	Bottom	yes	ø 12 mm			
0710068	M9x1	>40 <200	Yes	Ø 6 mm , 16 mm long	3/8"	no	no	no	1/2"-3/8"	3/8"	elbow 3/8"	Bottom				
0710073	M10x1	>110 <340 (red mark)	Yes	Ø 4 mm , 16 mm long	1/2"	no	no	fitted	3/8"	elbow 3/8"	Bottom					
0710094	M9x1	>40 <200	Yes	Ø 6 mm , 16 mm long	1/2"	Elbow 1/2"	Bottom	no	no	3/8"	Elbow 1/2"	Bottom				
0710106	M9x1	>40 <200	Yes	Ø 6 mm , 16 mm long	3/8"	no	no	no	1/2"-3/8"	3/8"	elbow 3/8"	Bottom				
0710117	M9x1	>40 <200	Yes	Ø 6 mm , 16 mm long	1/2"	no	no	fitted	3/8"	no	No	no	no			
0710119	M10x1	>40 <200	Yes	Ø 4 mm , 16 mm long	1/2"	Elbow 1/2"	Bottom	no	no	3/8"	no	No	no	no		
0710125	M10x1	>40 <200	Yes	Ø 4 mm , 16 mm long	1/2"	Elbow 1/2"	Bottom	yes	ø 16 mm	3/8"	Straight brass 30 mm long (0.974.085)	No	yes	ø 16 mm		
0710129	M9x1	>40 <200	Yes	Ø 6 mm , 16 mm long	3/8"	no	no	no	1/2"-3/8"	Plugged	No					
0710133	M9x1	>40 <200	no	Ø1/4, 16 mm long	1/2"	no	no	fitted	3/8"	no	No	no	no			
0710134	M9x1	>40 <200	no	Ø1/4, 16 mm long	1/2"	no	no	fitted	3/8"	no	No	no	no			
0710136	M10x1	>40 <200	Yes	Ø 6 mm , 16 mm long	3/8"	no	no	no	1/2"-3/8"	3/8"	no	No	no	no		
0710148	M10x1	>40 <200	Yes	Ø 6 mm , 16 mm long	1/2"	no	no	fitted	3/8"	elbow 3/8"	Bottom					
0710162	M10x1	>40 <200	Yes	Ø 4 mm , 16 mm long	1/2"	no	20 mm long	ø 16 mm	3/8"	no	No	no	no			

Secondary Outlet	Thermostat range	knob setting	Capillary dimensions (L) [mm]	Bulb dimensions (D, L) [mm]	P.R. or output flow adj.	Minimum rate screw Drilled ϕ	Cover (sand coloured)	Push buttons colour	Knob	Piezo igniter
	13-38	cal.38°C knob7	1050	8x120	No P.R. No o.f.adj. inlet&outlet in line (Blanking plate)	No	Left index	Sand	Sand knob 0.916.111 L.H. reference	Square piezo (sand)
	13-38	cal.38°C knob7	1050	8x120	3-18 mbar Pi 15 Po 11 Flow 1.37 m3/h	No	Left index	Sand	Sand knob 0.916.111 L.H. reference	Square piezo (sand)
M14x1 Plugged	13-38	cal.38°C knob7	1050	8x120	No P.R. No Outlet flow adj. + bottom outlet 3/8"	0,7	Compact cover (with piezo, without plastic plug)	Black	Black knob (0.916.092) L.H. Ref.	Piezo with mounting bracket tapping the side outlet
	13-38	cal.38°C knob7	1050	8x120	No P.R. No Outlet flow adj. + bottom outlet 3/8"	0,7	Compact cover (with piezo, without plastic plug)	Black	Black knob (0.916.092) L.H. Ref.	Piezo with mounting bracket tapping the side outlet
	13-31	cal.20°C knob 3	1050	8x155	3-18 mbar Pi 15 Po 11 Flow 1.37 m3/h	0,4	No	Black	Black knob (0.916.092) L.H. Ref.	No
	13-38	cal.20°C knob 3			3-18 mbar with stop pos. Pi 17 Po 10.7 Flow m3/h 2.30	No	Left index	Black	Black knob (0.916.092) L.H. Ref.	Square piezo (black)
	13-38	cal.20°C knob 3			3-18 mbar with stop pos. Pi 15 Po 11 Flow m3/h 1.37	1	Left index	Black	Black knob (0.916.092) L.H. Ref.	Square piezo (black)
	13-38	cal.38°C knob7	1050	8x120	3-18 mbar Pi 15 Po 11 Flow 1.37 m3/h	Not drilled screw fitted	Right index	Black	Black knob - 0.916.101 R.H. reference	Square piezo (black)
	13-31	cal.20°C knob 3	1050	8x155	3-18 mbar Pi 15 Po 11 Flow 1.37 m3/h	No	No	Black	Black knob (0.916.092) L.H. Ref.	No
	13-38	cal.38°C knob7	1050	8x120	Outlet flow adjuster	Not drilled screw fitted	No	Black	Black knob (0.916.092) L.H. Ref.	No
	13-38	cal.38°C knob7	1050	8x120	3-18 mbar Pi 15 Po 11 Flow 1.37 m3/h	1,3	Left index	Sand	Sand knob 0.916.111 L.H. reference	Square piezo (sand)
	20-90	cal. 90°C			3-18 mbar Pi 15 Po 11 Flow 1.37 m3/h	Not drilled screw fitted	Left index	Black	Black knob (0.916.092) L.H. Ref.	Square piezo (black)
manual					No P.R. No o.f.adj. inlet&outlet in line (Blanking plate)	Not drilled screw fitted	No	Black	Black knob - 0.916.096 R.H. reference	No
	13-38	cal.38°C knob7	1050	8x120	3-18 mbar Pi 15 Po 11 Flow 1.37 m3/h	Not drilled screw fitted	Left index	Black	Black knob (0.916.092) L.H. Ref.	No
	13-38	cal.38°C knob7	1050	8x120	3-18 mbar Pi 15 Po 11 Flow 1.37 m3/h	Not drilled screw fitted	Right index	Sand	Sand knob 0.916.102 R.H. reference	Square piezo (sand)
	13-38	cal.38°C knob7	1050	8x120	3-18 mbar Pi 15 Po 11 Flow 1.37 m3/h	0,4	No	Black	Black knob (0.916.092) L.H. Ref.	No
	13-38	cal.38°C knob7	1050	8x120	Outlet flow adjuster	Not drilled screw fitted	Left index	Black	Black knob (0.916.092) L.H. Ref.	Square piezo (black)
	13-38	cal.38°C knob7	1050	8x120	3-18 mbar Pi 15 Po 11 Flow 1.37 m3/h	Not drilled screw fitted	Without index (0.903.052)	Sand	Sand knob 0.916.111 L.H. reference	No
	13-38	cal.38°C knob7	1050	8x120	No P.R. No o.f.adj. inlet&outlet in line (Blanking plate)	Not drilled screw fitted	Without index (0.903.052)	Sand	Sand knob 0.916.111 L.H. reference	No
	30-90	cal. 90°C			3-18 mbar Pi 15 Po 11 Flow 1.37 m3/h	1,7	Left index	Black	Black knob 0.916.126 L.H. ref.	No
	30-90	cal. 90°C			3-18 mbar Pi 15 Po 11 Flow 1.37 m3/h	2	Left index	Black	Black knob 0.916.126 L.H. ref.	Square piezo (black)
	13-38	cal.38°C knob7	1050	8x120	No P.R. No o.f.adj. inlet&outlet in line (Blanking plate)	No	No	Sand	Sand knob 0.916.111 L.H. reference	No

Codes	RoHS Version	TC connection	Magnet Unit [Drop out- hold in current, mA]	PTP (1)	Pilot connection	Inlet thread	inlet FLANGE (2)	Inlet elbow orient.	NUT	OLIVE	Reducer	Outlet thread	Outlet FLANGE	Outlet elbow fi. orient.	NUT	OLIVE
0710164		M9x1	>40 <200	W	Ø 6 mm, 16 mm long	1/2"	no		no	fitted		3/8"	no	No	no	no
0710170		M9x1	>40 <200	Yes	Ø1/4, 16 mm long	1/2"	no		no	fitted		3/8"	no	No	no	no
0710173		M10x1	>110 <340 (red mark)	Yes	Ø 4 mm , 16 mm long	1/2"	Elbow 1/2"	Bottom	yes	ø 16 mm		3/8"	Elbow 1/2"	Bottom	yes	ø 16 mm
0710176		M9x1	>40 <200	Yes	Ø 6 mm, 16 mm long	1/2"	no		no	fitted		3/8"	no	No	no	no
0710182		M10x1	>40 <200	Yes	Ø 4 mm , 16 mm long	3/8"	Elbow 3/8"	Bottom	yes	ø 12 mm		3/8"	Straight brass 30 mm long (0.974.085)	No	yes	ø 12 mm
0710193		M9x1	>40 <200	Yes	Ø 6 mm, 16 mm long	1/2"	no		no	fitted		3/8"	no	No	no	no
0710194		M10x1	>40 <200	Yes	Ø 4 mm , 16 mm long	1/2"	Elbow 1/2"	Side	no	no		3/8"	no	No	no	no
0710195		M10x1	>110 <340 (red mark)	Yes	Ø 4 mm , 16 mm long	1/2"	no		no	fitted		Plugged		No		
0710196		M10x1	>110 <340 (red mark)	Yes	Ø 4 mm , 16 mm long	3/8"	Elbow 3/8"	Bottom	no	no		3/8"	Straight brass 30 mm long (0.974.085)	No		
0710198		M10x1	>110 <340 (red mark)	Yes	Ø 4 mm , 16 mm long	1/2"	no		no	fitted		3/8"	elbow 3/8"	Bottom	yes	ø 12 mm
0710199		M9x1	>40 <200	Yes	Ø 6 mm, 16 mm long	1/2"	Elbow 1/2"	Bottom	no	no		3/8"	Elbow 1/2"	Bottom		
0710203		M9x1	>40 <200	Yes	Ø 6 mm, 16 mm long	1/2"	Elbow 1/2"	Bottom	no	no		3/8"	Elbow 1/2"	Bottom		
0710204		M9x1	>40 <200	Yes	Ø 4 mm , 16 mm long	3/8"	Elbow 3/8"	Top	no	no		3/8"	elbow 3/8"	Bottom		
0710207		M10x1	>40 <200	Yes	Ø 4 mm , 16 mm long	3/8"	Elbow 3/8"	Bottom	yes	ø 12 mm		3/8"	Straight brass 30 mm long (0.974.085)	No	yes	ø 12 mm
0710209		M9x1	>40 <200	Yes	Ø 6 mm, 16 mm long	1/2"	no		no	fitted		3/8"	no	No	no	no
0710210		M9x1	>40 <200	no	Ø1/4, 16 mm long	1/2"	no		no	fitted		3/8"	Elbow 3/8" + P.T.Point sx Rc1/8"	Bottom		
0710212		M10x1	>40 <200	W	Ø 4 mm , 16 mm long	1/2"	no		no	fitted		3/8"	no	No	no	no
0710215		M9x1	>40 <200	Yes	Ø 6 mm, 16 mm long	1/2"	no		no	fitted		3/8"	no	No	no	no
0710216		M10x1	>40 <200	Yes	Ø 4 mm , 16 mm long	1/2"	no		no	fitted		3/8"	no	No	no	no
0710218		M10x1	>110 <340 (red mark)	yes	No	1/2"	no		no	fitted		3/8"	no	No	no	no
0710221		M9x1	>40 <200	Yes	Ø 6 mm, 16 mm long	1/2"	no		no	fitted		3/8"	no	No	no	no
0710222		M9x1	>40 <200	Yes	Ø 4 mm , 16 mm long	3/8"	Elbow 3/8"	Top	no	no		3/8"	no	No	no	no
0710225		M9x1	>40 <200	Yes	No	1/2"	no		no	fitted		3/8"	no	No	no	no
0710227		M10x1	>40 <200	Yes	Ø 4 mm , 16 mm long	1/2"	Elbow 1/2"		no	no		3/8"	Elbow 1/2"	Bottom	no	no

Secondary Outlet	Thermostat range	knob setting	Capillary dimensions (L) [mm]	Bulb dimensions (D, L) [mm]	P.R. or output flow adj.	Minimum rate screw Drilled ϕ	Cover (sand coloured)	Push buttons colour	Knob	Piezo igniter
	13-38	cal.38°C knob7	1050	8x120	3-18 mbar Pi 25 Po 15 Flow m3/h 0.400	0,5	No	Black	Black knob - 0.916.101 R.H. reference	No
	manual				No P.R. No o.f.adj. inlet&outlet in line (Blanking plate)	Not drilled screw fitted	Without index (0.903.052)	Black	No	No
	13-38	cal.38°C knob7	1050	8x120	3-18 mbar Pi 15 Po 11 Flow 1.37 m3/h	No	No	Black	Extension for remote control	No
	25-95	cal.95°C	1050	8x95	3-18 mbar Pi 15 Po 11 Flow 1.37 m3/h	2,4	Left index	Black	Black knob 0.916.126 L.H. ref.	No
	13-38	cal.38°C knob7	1050	8x120	3-18 mbar Pi 15 Po 11 Flow 1.37 m3/h	1,3	No	Black	Black knob (0.916.092) L.H. Ref.	No
	40-72	cal. 72°C	670	12x90	3-18 mbar Pi 15 Po 11 Flow 1.37 m3/h	Not drilled screw fitted	Without index (0.903.052)	Black	Black knob (2.116.184) L.H. reference	No
M14x1 side	13-38	cal.38°C knob7	1050	8x120	15-30 mbar Pi 24 Po 20 Flow 1.37 m3/h	1,6	Left index	Sand	Sand knob 0.916.111 L.H. reference	Square piezo (sand)
M14x1 side	13-31	cal.20°C knob 3	1050	8x155		0,4	No	Black	Black knob (0.916.092) L.H. Ref.	No
	13-31	cal.20°C knob 3	1050	8x155	outlet flow adjuster	0,4	No	Black	Black knob (0.916.092) L.H. Ref.	No
	13-38	cal.38°C knob7	1050	8x120	3-18 mbar Pi 15 Po 11 Flow 1.37 m3/h	1,3	No	Black	Extension for remote control	No
	30-90	cal. 90°C			3-18 mbar Pi 15 Po 11 Flow 1.37 m3/h	Not drilled screw fitted	No	Black	Black knob 0.916.126 L.H. ref.	No
	20-75	cal.75°C	1300	4x172	No P.R. No o.f.adj. inlet&outlet in line (Blanking plate)	Not drilled screw fitted	Left index	Black	Black knob - customer name printing	Square piezo (black)
	40-90	cal.65°C 1°stop	1050	8x95	3-18 mbar Pi 18 Po 14.1 Flow 0.50	0,7	Left index	Black	Black knob 2.116.095 L.H. ref.	No
	13-38	cal.38°C knob7	1050	8x120	3-18 mbar with stop pos. Pi 15 Po 11 Flow m3/h 1.37	No	Left index	Black	Black knob (0.916.092) L.H. Ref.	Square piezo (black)
	40:72	cal. 72°C	870	12x90	No P.R. No o.f.adj. inlet&outlet in line (Blanking plate)	Not drilled screw fitted	Without index (0.903.052)	Black	Black knob (2.116.184) L.H. reference	No
	13-29	cal. 29 knob 7			3-18 mbar Pi 15 Po 11 Flow 1.37 m3/h	Plug fitted (0.972.055)	No	Sand	Sand knob 0.916.111 L.H. reference	No
	13-38	cal.38°C knob7	1050	8x120	3-18 mbar Pi 25 Po 15 Flow m3/h 0.400	1,4	No	Black	Black knob - 0.916.101 R.H. reference	No
	20-75	cal.75°C			No P.R. No o.f.adj. inlet&outlet in line (Blanking plate)	Not drilled screw fitted	Left index	Black	Black knob - customer name printing	No
M14x1 side	30-90	cal. 90°C			3-18 mbar Pi 15 Po 11 Flow 1.37 m3/h	Not drilled screw fitted	Left index	Black	Black knob 0.916.126 L.H. ref.	No
M14x1 Plugged	13-31	cal.20°C knob 3	1050	8x155		0,4	No	Black	Black knob (0.916.092) L.H. Ref.	No
	40:72	cal. 72°C	670	12x90	3-18 mbar Pi 15 Po 11 Flow 1.37 m3/h	Not drilled screw fitted	Without index (0.903.052)	Black	Black knob (2.116.184) L.H. reference	No
	40-90	cal.65°C 1°stop	1050	8x95	3-18 mbar Pi 18 Po 14.1 Flow 0.50	0,7	Left index	Black	Black knob 2.116.095 L.H. ref.	No
	30-90	cal. 90°C			3-18 mbar Pi 15 Po 11 Flow 1.37 m3/h	Not drilled screw fitted	No	Black	Black knob 0.916.126 L.H. ref.	No
	13-38	cal.38°C knob7	1050	8x120	3-18 mbar Pi 15 Po 11 Flow 1.37 m3/h	0,4	Left index	Black	Black knob (0.916.092) L.H. Ref.	Square piezo (black)



Codes	RoHS Version	TC connection	Magnet Unit: [Drop out- hold in current, mA]	PTP (1)	Pilot connection	Inlet thread	inlet FLANGE (2)	Inlet elbow orient.	NUT	OLIVE	Reducer	Outlet thread	Outlet FLANGE	Outlet elbow fi. orient.	NUT	OLIVE
0710228	M10x1	>110 <340 (red mark)	Yes	Ø 4 mm , 16 mm long	1/2"	no	no	no	fitted			3/8"	no	No	no	no
0710235	M9x1	>40 <200	Yes	Ø 6 mm, 16 mm long	3/8"	no	no	no	no	1/2"-3/8"		3/8"	elbow 3/8"	Bottom		
0710236	M9x1	>40 <200	Yes	Ø1/4, 16 mm long	1/2"	no	no	no	fitted			3/8"	no	No	no	no
0710251	M9x1	>40 <200	yes	No	1/2"	no (2)	no	no	fitted			3/8"	no (with threaded flanges mounting holes)	No	no	no
0710252	M9x1	>40 <200	yes	No	1/2"	no (2)	no	no	fitted			3/8"	no (with threaded flanges mounting holes)	No	no	no
0710501	11/32 ASA	> 45 < 150	C	7/16UNS-24, Ø 1/4", 21 mm long	1/2 NPT	no	no	no	fitted			3/8 NPT	no	No	no	no
0710502	11/32 ASA	> 45 < 150	C	7/16UNS-24, Ø 1/4", 21 mm long	1/2 NPT	no	no	no	fitted			3/8 NPT	no	No	no	no
0710505	11/32 ASA	> 45 < 150	C	7/16UNS-24, Ø 1/4", 21 mm long	1/2 NPT	no	no	no	fitted			3/8 NPT side	no	No	no	no
0710506	11/32 ASA	> 45 < 150	C	7/16UNS-24, Ø 1/4", 21 mm long	1/2 NPT	no	no	no	fitted			3/8 NPT side	no	No	no	no
0710603	M9x1	>40 <200	Yes	Ø 6 mm, 16 mm long	3/8"	Elbow 3/8"	Bottom	no	no			3/8"	elbow 3/8"	Bottom		
0710618	M10x1	>40 <200	Yes	Ø 4 mm , 16 mm long	3/8"	Straight 3/8"	Bottom	yes	ø 12 mm			3/8"	Straight brass 30 mm long (0.974.085)	No		
0710619	M10x1	>40 <200	Yes	Ø 4 mm , 16 mm long	3/8"	Elbow 3/8"	Bottom	yes	ø 12 mm			3/8"	Straight brass 30 mm long (0.974.085)	No		
0710646	M9x1	>40 <200	Yes	Ø1/4, 16 mm long	1/2"	no	no	no	fitted			3/8"	no	No	no	no
0710647	M9x1	>40 <200	Yes	Ø 6 mm, 16 mm long	1/2"	no	no	no	fitted			3/8"	no	No	no	no
0710648	M9x1	>40 <200	Yes	Ø 6 mm, 16 mm long	1/2"	Elbow 1/2"	Bottom	no	no			3/8"	Elbow 1/2"	Bottom		
0710650	M9x1	>40 <200	yes	No	1/2"	no (2)	no	no	fitted			3/8"	no (with threaded flanges mounting holes)	No	no	no
0710651	M9x1	>40 <200	yes	No	1/2"	no (2)	no	no	fitted			3/8"	no (with threaded flanges mounting holes)	No	no	no
0710652	M9x1	>40 <200	yes	No	1/2"	no (2)	no	no	fitted			3/8"	no (with threaded flanges mounting holes)	No	no	no
0710653	M9x1	>40 <200	yes	No	1/2"	no (2)	no	no	fitted			3/8"	no (with threaded flanges mounting holes)	No	no	no
0710654	M9x1	>40 <200	yes	No	1/2"	no (2)	no	no	fitted			3/8"	no (with threaded flanges mounting holes)	No	no	no
0710655	M9x1	>40 <200	yes	No	1/2"	no (2)	no	no	fitted			3/8"	no (with threaded flanges mounting holes)	No	no	no

Secondary Outlet	Thermostat range	knob setting	Capillary dimensions (L) [mm]	Bulb dimensions (D, L) [mm]	P.R. or output flow adj.	Minimum rate screw Drilled ϕ	Cover (sand coloured)	Push buttons colour	Knob	Piezo igniter
	37-72	cal. 72°C	670	10x51	3-18 mbar Pi 15 Po 11 Flow 1.37 m ³ /h	Not drilled screw fitted	Without index (0.903.052)	Black	Black knob (2.116.184) L.H. reference	Square piezo (sand)
	13-38	cal.38°C knob7	1050	8x120	Outlet flow adjuster	0,8	No	Black	Black knob (0.916.092) L.H. Ref.	No
	110-190	cal.190°C	1050	6x73	No P.R. No o.f.adj. inlet&outlet in line (Blanking plate)	Not drilled screw fitted	No/Left index	Black	Sand knob 0.916.111 L.H. reference	No
	13-38	cal.38°C knob7	1050	8x120	3-18 mbar Pi 15 Po 11 Flow 1.37 m ³ /h	Not drilled screw fitted	No	Black	No	No
	13-38	cal.38°C knob7	1050	8x120	No P.R. No o.f.adj. inlet&outlet in line (Blanking plate)	Not drilled screw fitted	No	Black	No	No
	13-38	cal.38°C knob7	1050	8x120		No	Without index (0.903.052)	Black	Extension for remote control	No
	13-38	cal.38°C knob7	1050	8x120		No	Without index (0.903.052)	Black	Extension for remote control	No
	13-38	cal.38°C knob7	1050	8x120	NG Pi 7" Po 5.5" Flow m ³ /h 1.01 (90000 btu)	Plug fitted (0.972.055)	Without index (0.903.052)	Black	Extension for remote control	No
	13-38	cal.38°C knob7	1050	8x120	LPG. Pi 12" Po 10.5" Flow m ³ /h 2.54 (90000 btu)	Plug fitted (0.972.055)	Without index (0.903.052)	Black	Extension for remote control	No
	100-340	cal. 340°C knob max	1050	5x68	No P.R. No o.f.adj. inlet&outlet in line (Blanking plate)	Not drilled screw fitted	Left index	Black	Black knob (0.916.124) L.H. Ref.	No
	120-340	cal.340°C knob Max	1050	5x68	No P.R. No o.f.adj. inlet&outlet in line (Blanking plate)	0,5	Left index	Black	Black knob (0.916.124) L.H. Ref.	Square piezo (black)
	120-340	cal.340°C knob Max	1050	5x68	No P.R. No o.f.adj. inlet&outlet in line (Blanking plate)	0,5	Left index	Black	Black knob (0.916.124) L.H. Ref.	Square piezo (black)
	140-340	cal.340°C knob Max	1500	5x68	No P.R. No o.f.adj. inlet&outlet in line (Blanking plate)	Not drilled screw fitted	Left index	Black	Sand knob 0.916.111 L.H. reference	No
	30-100	cal 310	1300	4x72	No P.R. No o.f.adj. inlet&outlet in line (Blanking plate)	Not drilled screw fitted	No	Black	No	No
	120-340	cal.340°C knob Max	1300	4x72	No P.R. No o.f.adj. inlet&outlet in line (Blanking plate)	Not drilled screw fitted	Without index (0.903.052)	Black	Black knob (0.916.092) L.H. Ref.	No
	100-340		1050	5x68	No P.R. No o.f.adj. inlet&outlet in line (Blanking plate)	Not drilled screw fitted	No	Black	No	No
	100-340		1050	5x68	3-18 mbar Pi 15 Po 11 Flow 1.37 m ³ /h	Not drilled screw fitted	No	Black	No	No
	100-340	cal.340°C knob Max	1750	5x68	No P.R. No o.f.adj. inlet&outlet in line (Blanking plate)	Not drilled screw fitted	No	Black	No	No
	70-270		1050	5x104	No P.R. No o.f.adj. inlet&outlet in line (Blanking plate)	Not drilled screw fitted	No	Black	No	No
	100-340	cal.340°C knob max	1050	4x72	No P.R. No o.f.adj. inlet&outlet in line (Blanking plate)	Not drilled screw fitted	No	Black	No	No
	100-340	cal.340°C knob max	1050	4x72	3-18 mbar Pi 15 Po 11 Flow 1.37 m ³ /h	Not drilled screw fitted	No	Black	No	No

Codes	RoHS Version	TC connection	Magnet Unit: [Drop out- hold in current, mA]	PTP (1)	Pilot connection	Inlet thread	inlet FLANGE (2)	Inlet elbow orient.	NUT	OLIVE	Reducer	Outlet thread	Outlet FLANGE	Outlet elbow fi. orient.	NUT	OLIVE
0710656	M10x1		>40 <200	Yes	No	1/2"	no (2)		no	no		3/8"	Straight brass 30 mm long (0.974.085)	No		
0710657	M9x1		>40 <200	yes	No	1/2"	no (2)		no	fitted		3/8"	no (with threaded flanges mounting holes)	No	no	no
0710702	M9x1		>40 <200	Yes	Ø 6 mm, 16 mm long	3/8"	Elbow 3/8"	Bottom	no	no		3/8"	elbow 3/8"	Bottom		
0710720	M9x1		>40 <200	Yes	Ø 6 mm, 16 mm long	3/8"	no		no	no	1/2"-3/8"	3/8"	no	No	no	no
0710724	M10x1		>40 <200	Yes	Ø 4 mm , 16 mm long	3/8"	Elbow 3/8"	Bottom	yes	ø 12 mm		3/8"	elbow 3/8"	Bottom	yes	ø 12 mm
0710740	M9x1		>40 <200	Yes	Ø1/4, 16 mm long	1/2"	no		no	fitted		3/8"	no	No	no	no
0710741	M9x1		>40 <200	Yes	Ø 6 mm, 16 mm long	1/2"	no		no	fitted		3/8"	no	No	no	no
0710742	M9x1		>40 <200	Yes	Ø 4 mm , 16 mm long	1/2"	no		no	fitted		3/8"	no	No	no	no
0710743	M9x1		>40 <200	Yes	Ø 6 mm, 16 mm long	3/8"	Elbow 3/8"	Bottom	no	no		3/8"	elbow 3/8"	Bottom		
0710744	M9x1		>40 <200	Yes	Ø 4 mm , 16 mm long	1/2"	no		no	fitted		3/8"	no	No	no	no
0710745	M10x1		>40 <200	Yes	Ø 4 mm , 16 mm long	1/2"	no		no	fitted		3/8"	elbow 3/8"	Bottom		
0710746	M10x1		>40 <200	Yes	Ø 4 mm , 16 mm long	3/8"	Elbow 3/8"	Bottom	yes	ø 12 mm		3/8"	elbow 3/8"	Bottom	yes	ø 12 mm
0710747	M9x1		>40 <200	Yes	Ø 6 mm, 16 mm long	3/8"	Elbow 3/8"	Bottom	no	no		3/8"	elbow 3/8"	Bottom		
0710750	M9x1		>40 <200	yes	No	1/2"	no (2)		no	fitted		3/8"	no (with threaded flanges mounting holes)	No	no	no
0710751	M9x1		>40 <200	yes	No	1/2"	no (2)		no	fitted		3/8"	no (with threaded flanges mounting holes)	No	no	no
0710752	M9x1		>40 <200	yes	No	1/2"	no (2)		no	fitted		3/8"	no (with threaded flanges mounting holes)	No	no	no
0710754	M9x1		>40 <200	yes	No	1/2"	no (2)		no	fitted		3/8"	no (with threaded flanges mounting holes)	No	no	no
0710756	M9x1		>40 <200	yes	No	1/2"	no (2)		no	fitted		3/8"	no (with threaded flanges mounting holes)	No	no	no

Secondary Outlet	Thermostat range	knob setting	Capillary dimensions (L) [mm]	Bulb dimensions (D, L) [mm]	P.R. or output flow adj.	Minimum rate screw Drilled ϕ	Cover (sand coloured)	Push buttons colour	Knob	Piezo igniter
	120-340	cal.340°C knob Max	1050	5x68	15-30 mbar Pi 24 Po 20 Flow 1.37 m ³ /h	0,5	Left index	Black	Black knob (0.916.124) L.H. Ref.	Square piezo (black)
	100-340	cal.340°C knob Max	1750	5x68	3-18 mbar Pi 15 Po 11 Flow 1.37 m ³ /h	Not drilled screw fitted	No	Black	No	No
	50-190	cal.190°C	1200	bicone sealing system	No P.R. No o.f.adj. inlet&outlet in line (Blanking plate)	Not drilled screw fitted	Without index (0.903.052)	Black	Black knob (0.916.124) L.H. Ref.	No
	30-100	cal 310	1300	4x72	No P.R. No o.f.adj. inlet&outlet in line (Blanking plate)	Not drilled screw fitted	Left index	Black	Black knob (0.916.124) L.H. Ref.	Square piezo (black)
	60-200	cal.200°C			No P.R. No o.f.adj. inlet&outlet in line (Blanking plate)	0,5	Left index	Black	Black knob (0.916.124) L.H. Ref.	Square piezo (black)
	120-200	cal.200°C	1050	bicone sealing system M14x1.5	No P.R. No o.f.adj. inlet&outlet in line (Blanking plate)	Not drilled screw fitted	Left index	Black	Sand knob 0.916.111 L.H. reference	No
	70-210	cal.210°C	1300		No P.R. No o.f.adj. inlet&outlet in line (Blanking plate)	Not drilled screw fitted	No	Black	No	No
	120-200	cal.200°C		bicone sealing system M14x1.5	3-18 mbar Pi 15 Po 11 Flow 1.37 m ³ /h	Not drilled screw fitted	Without index (0.903.052)	Black	Black knob (0.916.124) L.H. Ref.	Square piezo (black)
	120-200	cal.200°C		bicone sealing system M14x1.5	No P.R. No o.f.adj. inlet&outlet in line (Blanking plate)	Not drilled screw fitted	Without index (0.903.052)	Black	Black knob (0.916.124) L.H. Ref.	No
	120-200	cal.200°C		bicone sealing system (Rs 3/8)	3-18 mbar Pi 15 Po 11 Flow 1.37 m ³ /h	Not drilled screw fitted	Without index (0.903.052)	Black	Black knob (0.916.124) L.H. Ref.	Square piezo (black)
	140-220	cal.200°C		bicone sealing system (3/8NPT)	No P.R. No o.f.adj. inlet&outlet in line (Blanking plate)	Not drilled screw fitted	Left index	Black	Black knob (2116225) 0-140-180-220 L.H. reference	Square piezo (black)
	60-200	cal.200°C			3-18 mbar Pi 15 Po 11 Flow 1.37 m ³ /h	0,5	Left index	Black	Black knob (0.916.124) L.H. Ref.	Square piezo (black)
	135-215	cal.215°C		bicone sealing system M14x1.5	No P.R. No o.f.adj. inlet&outlet in line (Blanking plate)	Not drilled screw fitted	Without index (0.903.052)	Black	Black knob (0.916.124) L.H. Ref.	No
	50-190	cal. 190°C knob max.			No P.R. No o.f.adj. inlet&outlet in line (Blanking plate)	Not drilled screw fitted	No	Black	No	No
	50-190	cal. 190°C knob max.			3-18 mbar Pi 15 Po 11 Flow 1.37 m ³ /h	Not drilled screw fitted	No	Black	No	No
	50-190	cal.190°C	1050		3-18 mbar Pi 15 Po 11 Flow 1.37 m ³ /h	Not drilled screw fitted	No	Black	No	No
	110-190	cal.190°C	1050	cap G1/4"x26	3-18 mbar Pi 15 Po 11 Flow 1.37 m ³ /h	Not drilled screw fitted	No	Black	No	No
	110-190	cal.190°C knob max	1050	6x102	No P.R. No o.f.adj. inlet&outlet in line (Blanking plate)	Not drilled screw fitted	No	Black	No	No



Codes	RoHS Version	TC connection	Magnet Unit: [Drop out: hold in current, mA]	PTP (1)	Pilot connection	Inlet thread	inlet FLANGE (2)	Inlet elbow orient.	NUT	OLIVE	Reducer	Outlet thread	Outlet FLANGE	Outlet elbow fi. orient.	NUT	OLIVE
0710757	M9x1	>40 <200	yes	No	1/2"	no (2)			no	fitted		3/8"	no (with threaded flanges mounting holes)	No	no	no
0710758	M9x1	>40 <200	yes	No	1/2"	no (2)			no	fitted		3/8"	no (with threaded flanges mounting holes)	No	no	no
0710759	M9x1	>40 <200	yes	No	1/2"	no (2)			no	fitted		3/8"	no (with threaded flanges mounting holes)	No	no	no
0710760	M9x1	>40 <200	yes	No	1/2"	no (2)			no	fitted		3/8"	no (with threaded flanges mounting holes)	No	no	no
0710763	M9x1	>40 <200	Yes	Ø 4 mm , 16 mm long	1/2"	no	side		no	fitted		3/8"	no	No	no	no
0710764	M9x1	>40 <200	yes	No	1/2"	no (2)			no	fitted		3/8"	no (with threaded flanges mounting holes)	No	no	no
0710817	M9x1	>40 <200	yes	Ø 6 mm, 16 mm long	1/2"	no (2)			no	fitted		3/8"	no (with threaded flanges mounting holes)	No	no	no
0710819	M9x1	>40 <200	Yes	Ø1/4, 16 mm long	1/2"	no			no	fitted		3/8"	no	No	no	no
0710850	M9x1	>40 <200	yes	No	1/2"	no (2)			no	fitted		3/8"	no (with threaded flanges mounting holes)	No	no	no
0710851	M9x1	>40 <200	yes	No	1/2"	no (2)			no	fitted		3/8"	no (with threaded flanges mounting holes)	No	no	no
0710852	M9x1	>40 <200	yes	No	1/2"	no (2)			no	fitted		3/8"	no (with threaded flanges mounting holes)	No	no	no

(1) W = yes (screw without slot),
C = yes (captured screw)

(2) with threaded flanges mounting holes

Secondary Outlet	Thermostat range	knob setting	Capillary dimensions (L) [mm]	Bulb dimensions (D, L) [mm]	P.R. or output flow adj.	Minimum rate screw Drilled ϕ	Cover (sand coloured)	Push buttons colour	Knob	Piezo igniter
	110-190	cal.190°C knob max	1050	6x102	3-18 mbar Pi 15 Po 11 Flow 1.37 m ³ /h	Not drilled screw fitted	No	Black	No	No
	110-190	cal.190°C	1050	6x102	No P.R. No o.f.adj. inlet&outlet in line (Blanking plate)	Not drilled screw fitted	No	Black	No	No
	120-200	cal.200°C knob max	1050	6x102	3-18 mbar Pi 15 Po 11 Flow 1.37 m ³ /h	Not drilled screw fitted	No	Black	No	No
	110-190	cal.190°C	1050	cap G1/4"x26	No P.R. No o.f.adj. inlet&outlet in line (Blanking plate)	Not drilled screw fitted	No	Black	No	No
	120-200	cal.200°C		bicone sealing system M14x1.5	3-18 mbar Pi 15 Po 11 Flow 1.37 m ³ /h	Not drilled screw fitted	Without index (0.903.052)	Black	Extension for remote control	No
	110-190	cal.190°C knob max	1050	6x102	No P.R. No o.f.adj. inlet&outlet in line (Blanking plate)	Not drilled screw fitted	No	Black	No	No
	40-110	cal. 82°C knob 1 stop end			3-18 mbar Pi 15 Po 11 Flow 1.37 m ³ /h	0,7	Left index	Black	No	No
	40-110	cal.110°C knob max			No P.R. No o.f.adj. inlet&outlet in line (Blanking plate)	Not drilled screw fitted	Left index	Black	Sand knob 0.916.111 L.H. reference	No
	30-100	cal. 100°C knob max	1050	5x122	No P.R. No o.f.adj. inlet&outlet in line (Blanking plate)	Not drilled screw fitted	No	Black	No	No
	30-100	cal. 100°C knob max	1050	5x122	3-18 mbar Pi 15 Po 11 Flow 1.37 m ³ /h	Not drilled screw fitted	No	Black	No	No
	20-90	cal.90°C	1050		3-18 mbar Pi 15 Po 11 Flow 1.37 m ³ /h	Not drilled screw fitted	No	Black	No	No

Distributor: CALOR SRL
Str. Progresului nr. 30-40, sector 5, Bucuresti
tel: 021.411.44.44, fax: 021.411.36.14
www.calorserv.ro - www.calor.ro

